



赛尔集团
SELLERSUNIONGROUP

Touch-Rich

AIR BRAKE SYSTEMS

气阀系统

TRUCKS
BUSES
TRAILERS



www.touch-rich.com



ABOUT Touch-Rich

Touch-Rich auto parts was founded in 2007, we are a industry and trading integration company the main production of a professional manufacturer specialized n air brake valves making for heavy/medium-duty trucks, commercia vehicles, passenger vehicles, engineer-ing vehicles.

We have more than 2000 kinds of products which exported Europe,NA,SA,Middle east,Southeast Asia.

In face of the developing market Touch-Rich always keep quality and customers in first so we bring in ISO9001,ISO14001,TS16949 system to manage our purchase production quality selling logistics.

2020 Touch-Rich joined Sellers Union Group according to group policy “ Providing Excellent Supply Chain Service for Clients Worldwide” We based on all the sensors opened up full range of the truck parts for our customers 2022 we revenue 20 million dollars and continue improving.



ISO/TS 16949:2009



SGS



APPLICATION:SCANIA MERCEDES,VOLVO,DAF,MAN, RENAULT,IVECO,HYUNDAI FOTON, DONGFENG, FAW,HINO NISSAN, MIST SUBISHI,ISUZU.

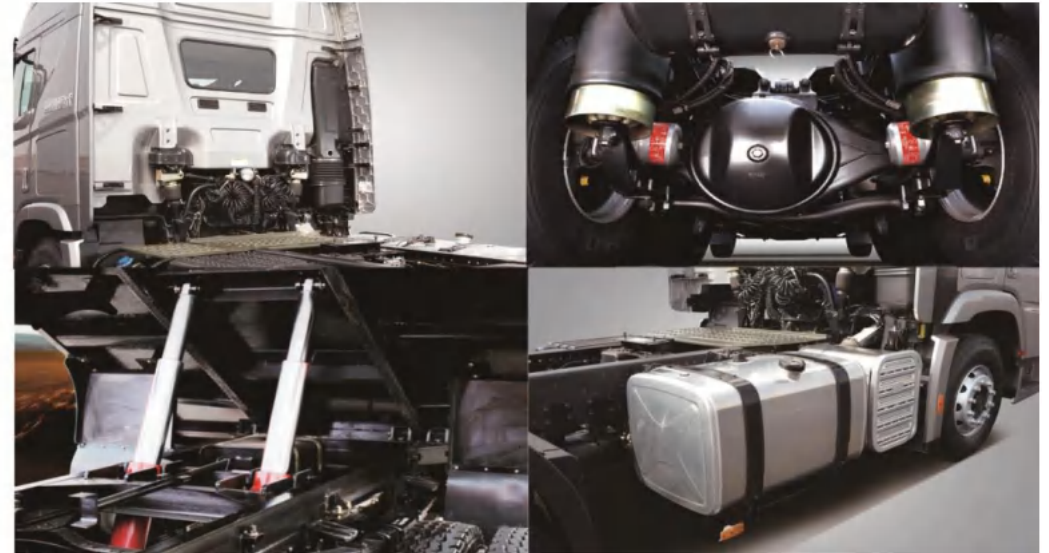

Our products and services for trucks, buses, trailers and agricultural vehicles.



2007	
2008	
2009	
2010	
2011	
2014	
2015	
2016	
2017	
2020	
2022	
2023	



20 years' experience in producing Air Brake Valve

- Running 5S, ERP System
- Specializing in OEM/ODM/OBM orders
- 5000+ items to choose from; 50 + new products annually
- Exporting to Europe, the Americas, Africa, the Middle East and Southeast Asia since 1996
- Compatible with Dongfeng, Foton, Sichuan Hyundai, Nanjing Iveco etc
- Up to 100,000 pieces monthly and completed orders in 30 days ;MOQ of 200 pieces
- English-speaking ,experienced R&D,QA and QC staff

Contact us today for more information.

Design research & Development 产品设计 & 研发

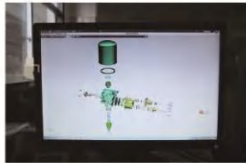

3-D analysis

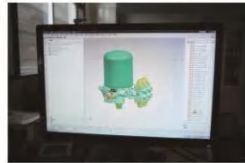

3-D design



Production & Processing 生产 & 加工



NC Workshop



Machining center



Oxidation treatment



Production line

Product test & Record 产品检测 & 记录



Qualified products



Clutch servo tester



Stress tester



Fatigue tester

Quality control & Factory inspection report 质量控制 & 出厂检验报告



Quality Control



Qualified products



Sample testing



Record information

Are you choosing the right supplier?

Achieve Industry 4.0

- We have big data
- Personal Tailor
- Fulfil the individual demand
- More and richer services
- Perfect and overall solution

Loading test & Feedback 装车测试 & 反馈

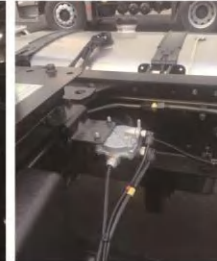

Our products passed the HYUNDAI TRUCKS RUNNING TEST and the aftermarket feedback showed that all properties are reached even surpassed the standard level.

Sales & Service 销售 & 服务



office



Sample room



Running WMS



International Trade D.

Packing & Transportation 包装 & 运输



Neutral & Color box



Shipping & Express



Automechanika Moscow



Automechanika Shanghai

Social responsibility 社会责任



Sorted collection & charging



Thorough recycling



Re manufacturing



Environmental protection

Air Dryer

空气干燥器

Air dryer can remove moisture in air by its built-in molecular sieve. The moisture contained in compressed air supplied by compressor is corrosive and makes lubricating diaphragm fall when condensed. At a lower temperature, it will probably endanger the line by freezing.

空气干燥器利用分子筛能除去压缩空气中的水份。来自空压机的压缩空气中含有水份，它冷凝后能造成锈蚀并使润滑膜失效，在气温较低时，还有使管道被冻住的危险。

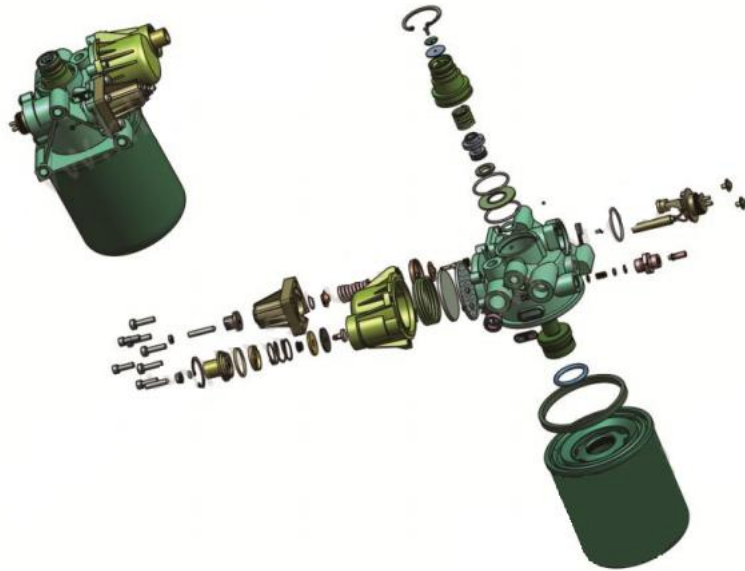

技术参数 Technical Features

最大工作气压 1300kpa	Max Operating pressure 1300kpa
工作介质 压缩空气	Permissible medium air
温度范围 -40℃~+80℃	Temperature range -40℃~+80℃
额定工作气压 800kpa	Operating pressure 800kpa
切断压力 810±20kpa	Shut off pressure range 810±20kpa



Foot Brake Valve

脚制动阀

Sensitive actuation of dual circuit service brake system during brake application and release.

在双回路主制动系统的制动过程和释放过程中实现灵敏的随动控制。

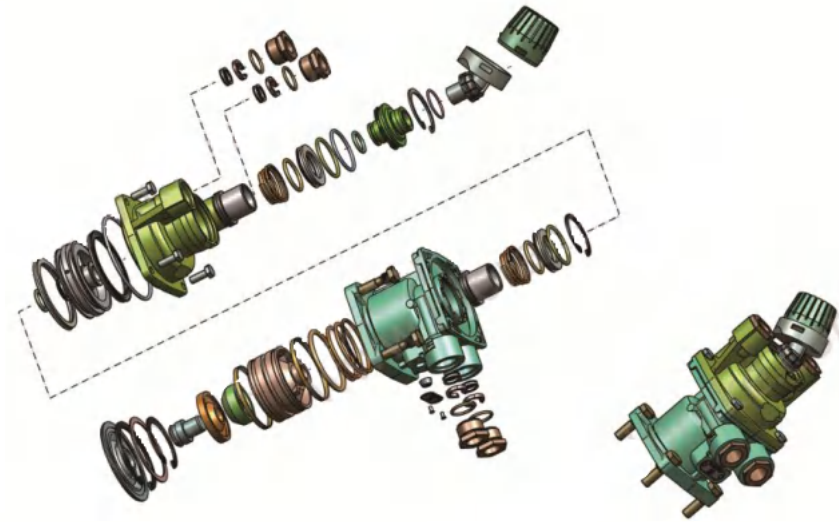

技术参数 Technical Features

最大工作气压 1000kpa	Max Operating pressure 1000kpa
工作介质 压缩空气	Permissible medium air
温度范围 -40℃~+80℃	Temperature range -40℃~+80℃
额定工作气压 800kpa	Operating pressure 800kpa



Relay Valve

继动阀

The relay valve is used where large reservoirs at the end of long lines are to be quickly filled with compressed air, for example, in trailer or semitrailer brake systems. In lorries the valve serves to shorten reaction and pressure build-up time.

继动阀用于长管路的末端，使储气筒的压缩空气快速充满制动气室，如在挂车或半挂车制动系统中。在载重汽车的制动系统里，继动阀起缩短反应时间和压力建立时间的作用。

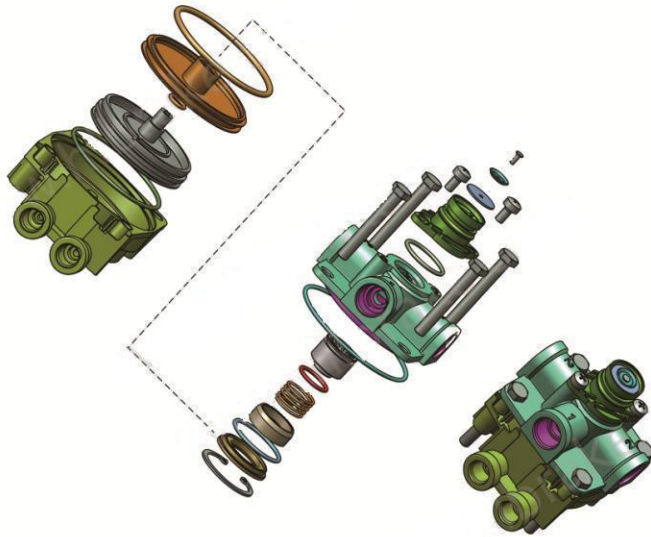

技术参数 Technical Features

最大工作气压 1300kpa	Max Operating pressure 1300kpa
工作介质 压缩空气	Permissible medium air
温度范围 -40°C~+80°C	Temperature range -40°C~+80°C
额定工作气压 1000kpa	Operating pressure 1000kpa



ABS Solenoid Valve

ABS电磁阀

ABS solenoid control valve, receive ECU control signal to control the brake chamber's pressure to rise, decrease, and protect.

ABS电磁调节阀，接收ECU发出控制信号，控制制动气室升压、降压、保压三个状态。

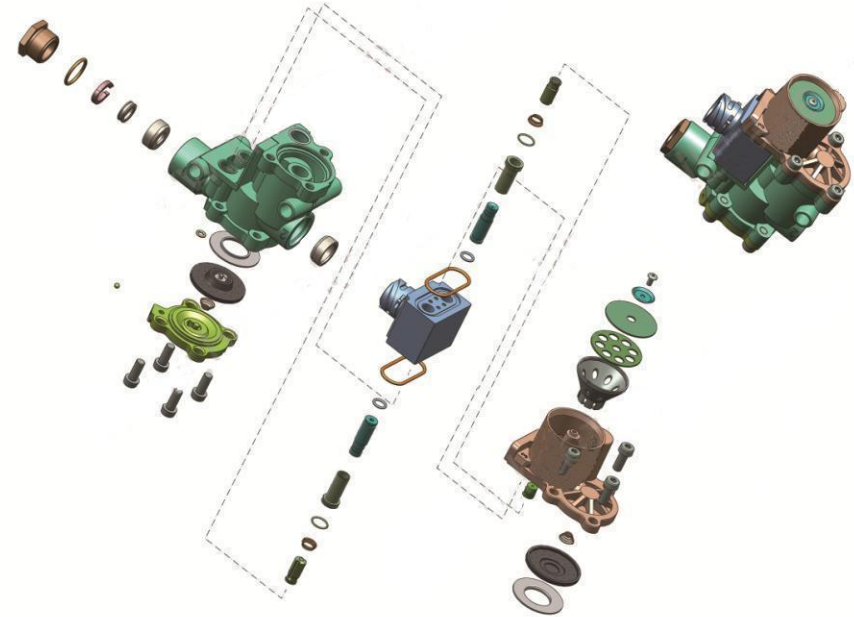

技术参数 Technical Features

最大工作气压 1300kpa	Max Operating pressure 1300kpa
工作介质 压缩空气	Permissible medium air
温度范围 -40°C~+80°C	Temperature range -40°C~+80°C
额定工作气压 1100 ⁺²⁰ kpa	Operating pressure 1100 ⁺²⁰ kpa
额定工作电压 24V DC	Nominal Voltage 24V DC
额定工作电流 1.65A	Nominal Current 1.65A



Gear Box Valve

变速箱阀

Switch on to ensure air supply when switch valve preselected, switch off to avoid maishift and synchronizer damage when shift finished.

预选时处于供气状态，换挡后切断气源，防止行驶过程跳档导致同步器损坏

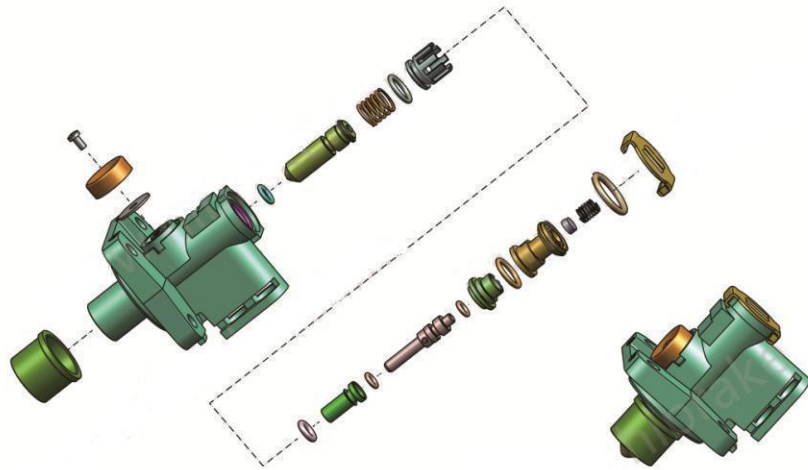

技术参数 Technical Features

最大工作气压 1000kpa	Max Operating pressure 1000kpa
工作介质 压缩空气	Permissible medium air
温度范围 -40℃~+80℃	Temperature range -40℃~+80℃
额定工作气压 800 ^{±10} kpa	Operating pressure 800 ^{±10} kpa



Solenoid Valve

电磁阀

Solenoid valve is used for air range shift.

电磁阀实现气路换向功能。

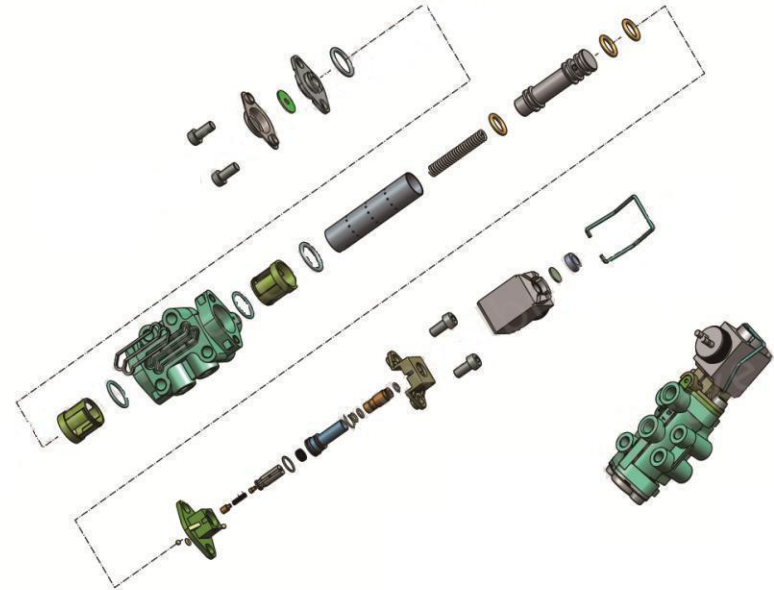

技术参数 Technical Features

最大工作气压 1000kpa	Max Operating pressure 1000kpa
工作介质 压缩空气	Permissible medium air
温度范围 -40℃~+80℃	Temperature range -40℃~+80℃
额定工作气压 810kpa	Operating pressure 810kpa



4324100000	4324100330 DAF 1505962	4324100070 Liebherr 502657388 Yutong 3529-00019	4324100100 SCANIA 1517979	4324100200 Neoplan 110275100
4324100330 IVECO 08160464 08160466	4324100350 IVECO 08160472 08160473	4324100750 DAF 1505220 IVECO 41031475	4324100830 SCANIA 1441751	4324100870 DAF 1505966
4324101020 DAF 1505967 MAN 81521026023	4324101140 MAN 81521026138 81521026120	4324101170 DAF 1517969 MAN 81521026098	4324101910 VOLVO 20410156 20546790	4324102500 DAF 1505223 MAN 81521026038
4324130010	4324150000 Hyundai	4324150290 DAF 1505232 MAN 1276700	4324150300 DAF 1505233	4324200000 4324200020 4324200080
4324210000 4324210070	4324210070 4324210080 Mercedes 0014310415	4324251010 VOLVO 20873849	4324251050 VOLVO 21480094	9324000010 DAF 1518168
9324000060 BENZ 0004303015	9324000140 BENZ A0004306315	9324000240 BENZ 0004301315	LA6228 MAN 81521026065	LA6700 BENZ 0004313615
LA6711 SCANIA 1628919 1629927	LA8001 RENAULT 5010260350	LA8006 RENAULT 5010098957	LA8016 RENAULT 5010260362	LA8041 RENAULT 5001848866

LA8063 RENAULT 5010525505	LA8065 RENAULT 5010422343	LA8073 RENAULT 5010525579	LA8076 RENAULT 5010422397	LA8125 IVECO 42536552 42536872
LA8130 DAF 1607424	LA8206 DAF 1285548	LA8222 IVECO 041017242 08160465	LA8226	LA8229 DAF 1517964
LA8234 DAF 1505967	LA8271 VOLVO 20416145 20409513	9325000030 9325000040	9325000060 9325000070	9325000130 9325000140
9325000350 Foton	9325001040	9325001100	ZB4400	ZB4535 0024310515
ZB4578 DAF 1374293 1443153 1374293	ZB4587 IVECO 41211254 41285078	ZB4800 BENZ	BW 800383 BW 800838 BENDIX	BW 801324 BENDIX
HALDEX 78985 SCANIA 1387553	HALDEX 78990 VOLVO 3962679	HALDEX 87282 VOLVO 3194898	HALDEX 87297 VOLVO 3194899	Air Dryer Base
4324206002	Air Dryer Base	Air Dryer Base	Air Dryer Base	EQ153 DONGFENG

4324102227	4324102207	4324100202	4324102202	4324109272
4329012232	4329012452	4329012462	4329012282	4329012442
1140100F	1391510 1139737F	AD-9 CARTRIDGE	9328900010 1077904X 107796	92528, 93522, 78964
1393551 1381813	41210029 92796 Haldex 504017778 Iveco	78968 Iveco 500308723	92796 Iveco 504017778	1393639
4324070120	4324070600	4324070700	ZB3150	1130654 187122
8946004512	8942600442 8942600402	8942600462 8942600472	8942600492	4324109312 SCANIA 1901211
4324100002 KIT	4324100012 KIT	4410435041(SV)	4410430021 4410430011(24V)	PRESSURE SENSOR (5V/24V)

9347000400	9347023000 9347023200 9347023400	9347022100 9347022210 9347022400	9347022500	9347050020
9347050050	9347050060	9347130040 9347130190	9347140100 9347140130 9347141250	9347141190 Iveco 99480157
9347141510 9347141520	9347141450 9347142110	9347147400 VOLVO 20716313 21225479	9325109582 SCANIA 1763422 1774873	AE4162
AE4448 AE4452	AE4158 AE4168 AE4170	AE4179 AE4428	AE4404 AE4422 AE4437	AE4440
AE4502 IVECO 042535024	AE4505	AE4510 DAF 1505128	AE4525 5010525808	AE4603 VOLVO 3197858 3197585
AE4604 VOLVO 20755195 3197588	AE4605 5010422971 5006143813	AE4609 81521516095 81521519095	AE4610 DAF 1367504	AE4612 NEOPLAN 11066148
AE4613 MAN 81521516093 IVECO 97166254	AE4615 A0004205771	AE4644 AE4648	AE4646	AE4800 BENZ 0034319706

4730170070 4730170080	9710021500	9710021510 9710021520	9710023040 9710023010	9710025310
9710025700	9710027000 9710027010	9730010100 9730010130 9730010200	9730060000	9730060010
9730110000 9730110010 9730110050	9730110020 SCANIA 1313871 DAF 1506486	9730110040 DAF 1305026 BENZ 0044296244	9730110500 DAF 1304903 SCANIA 1425183	9730112000 BENZ 0044297644 DAF 1504965
9730112010 DAF 1519332	9730112050 DAF 1506488 BENZ 0054291044	9730112060 RENAULT 5010260705 DAF 1518270	9730112080 IVECO 41211072	9730112500 MAN 81521166079
R-6 279180 280375	RE-6 281860 281865	R-8 286370 288221	R-8P 287114	R-12 102626 103912
R-12H 103009 065125	R-12P 065303	R-14 103028 103833	R-14H 103010 103294	RG-2 KN28500 KN28510 KN28520 KN28531
110 460 110 205	110 200 116 205	KN28080	KN28600 KN28601 KN28602 KN28603	KN30100 KN30200 KN30300 KN30400

59300-83401	MC838211	229501	277863 278998	286171
800629 800630 800631	286773 288383	4613072000 DAF 1506081	4613074790	4613150040 4613150080 4613150530
4613150120 4613150260	4613151800 DAF 1504971 SCANIA 1324663	4613152480 4613152610	4613152540 4613152580	4613152640 BENZ 0044314605 DAF 1518065
4613154790 4613154970	4613170000 4613170020	4613170060 VOLVO 3028741 MAN 84521306032	4613170080 4613170540 DAF 1506090	4613186030 4613186040
4613190080	4613192710 DAF 1518070 BENZ 0034311705	4613192740 DAF 1517495 BENZ 0044314905	4614911020 DAF 1518073 IVECO 02470415	4614945020 RENAULT 5031844787 DAF 1505317
0486200104	VOLVO 21390592	MB4630	MB4849/MB4847 MB4690	MB4694 DAF 1337184
MB4813 MB4815	MB4820 MB4825	DX75BA/DX75A DX75B	DX75BAY IVECO 500317963	DX95B/DX95A/DX95F/ DX95B/DX95BY

HAND BRAKE VALVE
Trucks, Buses, Trailers, Agricultural vehicles

9617011000	9617011050	9617020010	9617020040	9617210000 BENZ A0004307881
9617221500 9617221560	9617221510 9617221520	9617221600 DAF 664867	9617222120 9617222320	9617222520
9617222580 9617222840	9617222750 BENZ 0024302481	9617223050	9617223140 SCANIA 571125 DAF 1505328	9617223150
9617230010 DAF 0371274	9617230040 9617230380 DAF1505331	9617230210 DAF1505336 VOLVO 469271	9617230380	9617231000 DAF 1505337
9619230190 9617231120 DAF 1524310	9619231080 DAF 0559817	9617231110 9619232080 DAF 1518236	9617231020	9617230050 9617231040 BENZ 0024307881
9617232130 9617232150	9617232170 DAF 1506757 VOLVO 1408332	9617234210 BENZ 0034305981	HB1142	HB1143 VOLVO 9515443
APSA 5890	DPM92A	DPM94AAX	DPM95AAX	A6915 Red A6913 Bule

LEVELLING VALVE
SCANIA, MERCEDES, VOLVO, DAF, MAN, RENAULT, IVECO

4410500060	4410500070	4410500080 4410500100	4410500110	4410500120
4410500130	4410501000 4410501010	4410501200 4410501230 4410501230	4630320200	4640023300 VOLVO 1576736
4640060000 4640060010 VOLVO 1607728	4640060020 DAF 1325337	4640061000 DAF 1325336	SV1280 SV1281	SV1294
SV1295 VOLVO 3038069	SV1310 SV1361	SV1318 DAF 1518856 IVECO 04675513	4640070010 4640070140 4640070300	4640070020 4640070030
4640070070 RENAULT 5010260136	4640070080 RENAULT 5010260060	4640070100 SCANIA 1395776 1430545	4640070110 DAF 1518095 BENZ A0003284530	4640070190 VOLVO 20410492 20531965
0500005001 0500005002	0500005006 0500005007	90054007 1118884	0504002112	5010207803 0504002113
0504002107 9517678 K013741N00	VOLVO 21585711 21253672 20583428	VS-227	90555105	90554663 SCANIA 1407139 1451839



































GEAR BOX VALVE
Trucks, Buses, Trailers, Agricultural vehicles

				
SCANIA 1319557	VOLVO 8172628 1672230	VOLVO 1068951 1669297/8172627	VOLVO 1068952 1669279	VOLVO 1669324 1669277
				
VOLVO 1672231	VOLVO 1653156	SV3367 BENZ 0012606757	6038202043 9P919135	SV3388
				
SV3371	0012606357	9415400045	MAN 81521706156	FAST
				
0002601457 5710031040	0012602057 G155, G210	500067571	1653070 1669422	3192384
				
VOLVO 1521249 1653072	VOLVO 1521248 1667210/1669420	VOLVO 1521247	VOLVO 20775158 2077517/8171247	WG2203250010
				
SCANIA 1488083	SCANIA 1488083-1	SCANIA 1364636	DAF 1457275	DAF 1457276
				
SCANIA 0301484	SCANIA 1421322	SCANIA 1421324	SCANIA 1421323 1536305 1340232	SCANIA 1421325 1370354 1536307

SOLENOID VALVE
SCANIA, MERCEDES, VOLVO, DAF, MAN, RENAULT, IVECO

				
VOLVO 1078316 3165144	VOLVO 1078320	VOLVO 8143015	VOLVO 8143014	VOLVO 8143096
				
VOLVO 8143019 1610568 1594346	VOLVO 1625770	VOLVO 1078318	VOLVO 1078322	VOLVO 8143017
				
VOLVO 8143021	RENAULT 5010224047	4720706280	4720706390	4721706060
				
4721726000	4721726860	4721734280	4721737000	4722500000 4722500010
				
4722500070	4720174800	4721950040 4721950050 4721950090	4721950160 4721950180	4721950310 DAF 1518909 RENAULT 5021170197
				
4728800000	4728800300	4422002221	4631840310	9702600457
				
VOLVO 3944716	VOLVO 3944717	VOLVO 9957009	VOLVO 3944186	950364047

 970190050 APGA1605P	 TYPE 070	 TYPE 090	 TYPE 105	 9700511000 ZF 0501008846
 9700511020 9700511140 9700511260	 9700511070 9700511240	 9700511110 DAF 1518243 MAN 81307256014	 9700511280 BENZ 0012955607 DAF 1518246	 9700511310 RENAULT 5021170433 DAF 1505139
 9700511320 DAF 1518248 MAN 81307256031	 9700511360 DAF 0390486	 9700511510 BENZ 0002950818 DAF 1518250	 9700511560 SCANIA 1935596	 9700511580 9700511590 IVECO 99436210
 9700511760 DAF 1506459	 9700511830	 9700511900 BENZ 0002540147	 9700512090 SCANIA 1935597 DAF 1518254	 9700512170 9700512180
 9700512200 9700512260 DAF 1506463	 9700513070 9700514140 MAN 81307256053	 9700514020 RENAULT 5001837387 DAF 1504826	 9700514120 DAF 1506465 MAN 81307259084	 9700514150 RENAULT 5010452511 DAF 1519286
 9700514230 9700514070 9700512390	 9700514410 SCANIA 1935609 BENZ 0002540447	 9700514590 IVECO 504177095	 9700514660 MAN 81307256116	 9701500010 BENZ 0002500562
 VG3200 MAN 81307256027	 VG3204 IVECO 42061949	 VG3208 MAN 81307256032	 VG3261 MAN 81307256064	 VG3262 MAN 81307256049

 VG3264 VG3288 IVECO 41035646	 VG3269 VG3289 IVECO 41035647	 VG3361 VG3364 IVECO 99436210	 1000178631AM VOLVO 1927825 1784480/1523399	 622109AM SCANIA 360717 360719/575182
 622190AM SCANIA 374116	 622199AM SCANIA 1331770	 622504AM LEYLAND ACU8944	 624199AM SCANIA 1337966/575183	 625290AM LEYLAND AXU0132
 625359AM/627692AM 629683AM 1367453/1421186	 625375AM BENZ 0002952819	 625384AM RENAULT 5010244208	 625385AM RENAULT 5000673435	 625436AM/628027AM MAN 81307256074
 625524AM RENAULT 5010244224	 625586AM 62402AM MAN 81307256051	 626392AM VOLVO 1526523/1655639 1673067/267321	 626400AM DAF 1327940 1346863	 626639AM VOLVO 1521371/1655435
 626669AM	 626853AM RENAULT 5010245752	 627496AM MAN 81326556128 81326056111	 627498AM 1000332424AM DAF ATRA460	 628036AM DAF 1438606
 628259AM/627668AM DAF 1397120/1443522	 62848AM/627579AM 628450AM	 628449AM/627589AM DAF 1392205/1443529	 629134AM DAF 1617399	 629276AM 3192126/20524584 1672129/8171720
 629277AM 3192126/8171721 20524585/3192126	 629300AM 5001866284 5010545581	 629497AM	 630361AM 81307256107 81307256084	 4220100010

BRAKE VALVE
Trucks, Buses, Trailers, Agricultural vehicles

				
973002070 9730024020	9730025010 9730025200 9730025210	9730090010 9730090020 9730090100	9730093000	AC598C/AB2851 5010260241
				
4757100200 4757100220	4757110750 DAF 1504958 VOLVO 1628955	4757120040 DAF 1518127	4757145000 DAF 1325325 IVECO 3300868	4757155000 DAF 1506232
				
4753042010	9753000140	9753001100	9753030600	9753030850
				
9753034720 9753035030 9753035040	9753034730	9753034640 9753034740	DR3200	4325000200 4325000210
				
4341001230 4341001240	4341000240 4341001250	4750100130 4750100250	4750103000 4750103010	4750103080 4750103130
				
4750104000	4750150040 4750150310	1189393	3944252	275491
				
MC808717	A4740	0481009026 1606720	7545-1108900	16743

BRAKE VALVE
SCANIA, MERCEDES, VOLVO, DAF, MAN, RENAULT, IVECO

				
9735000000 9735000110	229859 229844 229813	289714	9630010010	9630010120 9630010130
				
4630130120	4630130140	4630131100	4630131140	4630131160
				
4630132000	4630220200 4630220210	4630360000 4630360010 0019976136	4756040110	452 002 1070
				
125180-8070	434 014 0000	434 208 0000 AE4105	434 208 0090	934 300 0030
				
278450 276566	276567	9630010510 9630010520	800516 800573	445101190 445101090
				
PNEUMATIC SWITCH VALVE	PNEUMATIC SWITCH VALVE	344 026 011 344 025 011 M22*1.5	344 026 031 344 025 031 M22*1.5	9522010010 9522010020
				
452 200 2110 452 200 0120	452 200 2120 452 200 0110	952 200 2220 952 200 2210	12306 12308	12136 12138

Touch-Rich



赛尔集团
SELLERSUNIONGROUP

PROVIDING EXCELLENT SUPPLY CHAIN
SERVICE FOR CLIENTS WORLDWIDE



Name: Hizen Zhu

Mobile: +86 13777071163

WhatsApp: +86 13777071163

E-mail: hizen_123@163.com

Address: Guanghua Road No.288, Yinzhou District,
Ningbo City, Zhejiang Province, China